

Einbausituation /
assembly situation
2:1

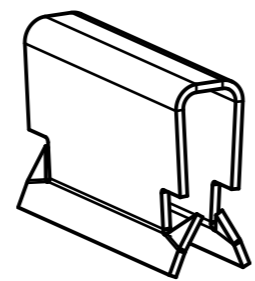

Isometrische Ansicht /
isometric view
2:1

013414-0-06	verzinkt / metallhaltige Korrosionsschutzbeschichtung, Farbe schwarz / Deltacoll, Farbe schwarz zinc plated / metallic corrosion protection coated, colour black / Deltacoll, colour black	5502
013414-0-05	metallhaltige Korrosionsschutzbeschichtung, Farbe schwarz metallic corrosion protection coated, colour black	5451
013414-0-03	impraegniert oiled	7000
Teil-Nr. / part no.	Oberflaeche / Farbe / finish / colour	Oberfl. Code/ finish code
Ausfuehrung / Execution		

Vor Auslegung einer automatisierten Verarbeitung des Teils sollte Ruecksprache mit Fa. ARaymond gehalten werden.
 Fully automatic processing of the part requires prior consultation with ARaymond.

Rev.	Anzahl/ quantity	Aenderungsbeschreibung / modification description	Datum/date	Name
Bb	-	Zeichnung ueberarbeitet nach AR-Gruppenstandard, Teil unveraendert	12.11.12	mj
-	-	Oberflaechenvariante entfernt (3300)	-	-



Teichstrasse 57
 Germany - 79511 Loerrach
 Phone +49 (0) 7621 174-0
 Fax +49 (0) 7621 174-225

Bei Verstaendnisproblemen beantragen Sie bitte beim Absender die deutsche Fassung vor jeder Anwendung.
 "CONDITIONS OF USE"
 This drawing and all information (the "Drawing") disclosed are the exclusive property of ARaymond. By using this Drawing the Addressee acknowledges and accepts that this Drawing (1) is covered by ARaymond' intellectual property rights or know-how and (2) is provided under the following conditions who represent a Deposit Agreement. This Drawing is for Addressee' Internal use only limited to its estimation. Without prior written consent of ARaymond, no permission or rights for any purpose, is hereby granted, such as, without any limitation, (1) the copy, in part or entirely, (2) and/or the presentation, in part or entirely, to any other third party outside the Addressee' company or in the company but with no interest (3) and/or the distribution of the Drawing, in part or entirely, in any medium (4) and/or the creation of any derivative work. In case of breach of these conditions, Addressee shall indemnify ARaymond from and against all damages (compensatory or consequential), costs, expenses and charges, caused or arising out of or attributable to its willful misconduct, fraud, negligence, infringement of ARaymond' intellectual property rights. If the Addressee does not accept these conditions, please notify ARaymond' sender immediately.

Intellectual property rights	vorbehalten / all rights reserved		Classification code	CCA--
Ersatz fuer/ substitutue for	013414_c_01/Ba/18.08.2006	Entw.Ref./ dev.ref.	Projekt-Nr./ project no.	47335
Masstab/ scale	Format	Allgemeintoleranz/ general tolerance	Datum/ date	12.11.2012
5:1	A3	±0.25	Erstellt von/ prepared by	M. Junge
Projektion / projection	ALL DIMENSIONS ARE IN MILLIMETERS	Freigegeben/ approved	20121122071604	
	Blechedicke/ mat. thickness DIN EN 10140	0.55	Volumen/ volume (mm³)	307.6
			Gewicht/ weight (g)	2.5
Oberfl. / finish	verzinkt zinc plated			Oberfl. Code/ finish code 3200
Werkstoffbehandl./ material treatment	zwischenstufenverguetet / austempered 435 ... 535 HV 5			
Werkstoff/ material	C67S DIN EN 10132-4			Mat. code 1000
Benennung/ title	U-Klammer edge clip			
Teil-Nr. / part no.	013414-0-01			Drawing type C:Customer
Kundenteile-Nr. / customer part no.	-			Blatt / sheet 1 / 1
CAD system & version ProE WF4			Dateiname / filename 013414-0C00	